

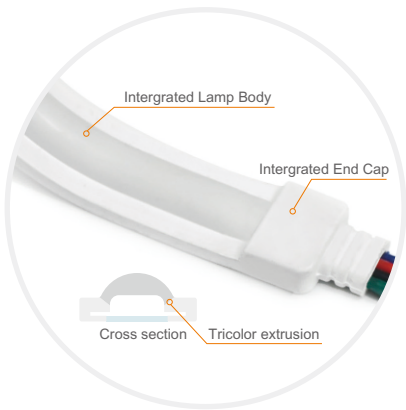

# COB LED STRIP PLUS

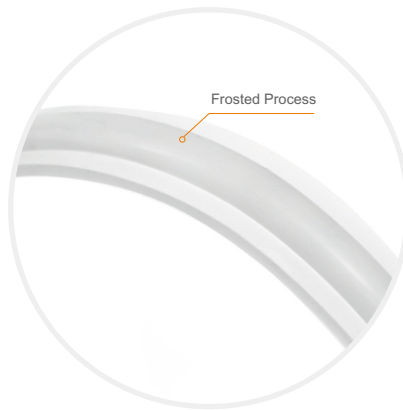

More extreme vision



More perfect touch

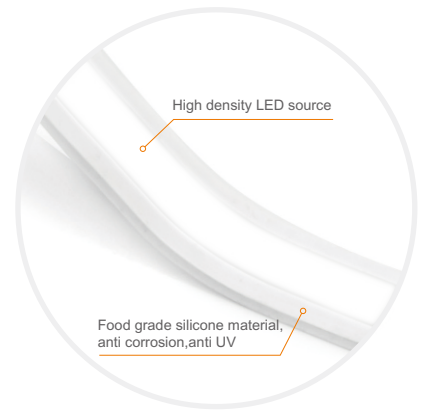

More stable performance

Specialized  
LED strip  
Manufacturer

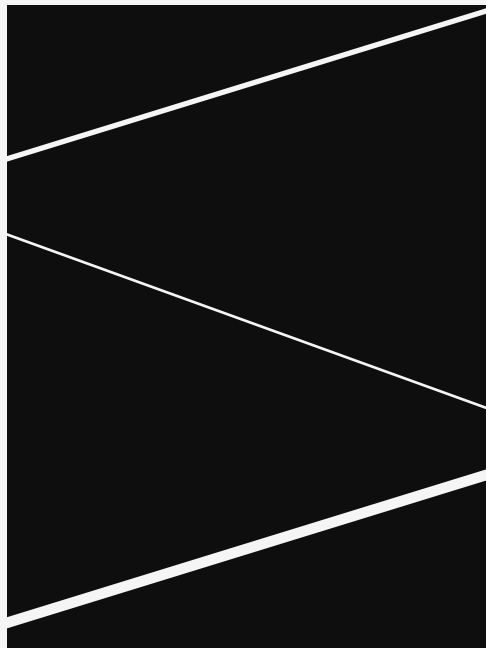

# Model : i-COB-SP12MM

## Parameter Table For 12MM

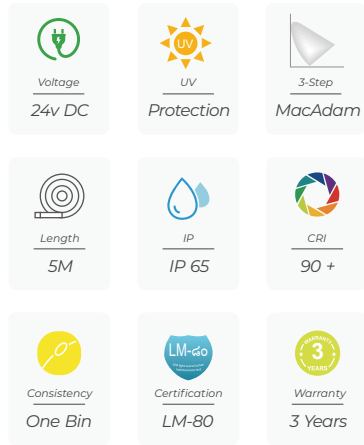

- Max. Run length refers to single side feed in serial connection.
- The given color temperature is the temperature of finished product.
- The given data are typical values due to the tolerances of the production process and the electrical components, values for light output and electrical power can vary up to 10%.

### Single-Color

CCT(K)	CRI	SDCM	Power(W)	Lumen (LM/M)	Efficiency (LM/W)	Unit Length (mm)	Max. Run Length (M)	Voltage
2400	>90	<5	5	429	85.9	25	5	DC24V
			10	826	82.6			
			15	1208	80.6			
2700	>90	<5	5	433	86.6	25	5	DC24V
			10	833	83.3			
			15	1244	82.9			
3000	>90	<5	5	436	87.3	25	5	DC24V
			10	840	84			
			15	1243	82.8			
3500	>90	<5	5	484	96.7	25	5	DC24V
			10	930	93			
			15	1364	91			
4000	>90	<5	5	442	88.4	25	5	DC24V
			10	851	85.1			
			15	1258	83.9			
5000	>90	<5	5	443	88.7	25	5	DC24V
			10	854	85.4			
			15	1259	84			
6500	>90	<5	5	450	90	25	5	DC24V
			10	867	86.7			
			15	1270	84.6			
R	--	--	5	142	28.4	25	5	DC24V
			10	281	28.1			
			15	416	27.7			
G	--	--	5	349	69.8	25	5	DC24V
			10	628	62.8			
			15	823	54.9			
B	--	--	5	62	12.4	25	5	DC24V
			10	121	12.1			
			15	176	11.7			
Yellow	--	--	5	88	17.6	25	5	DC24V
			10	200	20			
			15	294	19.6			
Orange	--	--	5	108	21.6	25	5	DC24V
			10	246	24.6			
			15	345	23			
Pink	--	--	5	274	54.8	25	5	DC24V
			10	519	51.9			
			15	755	50.3			

### Dimension structure

12MM

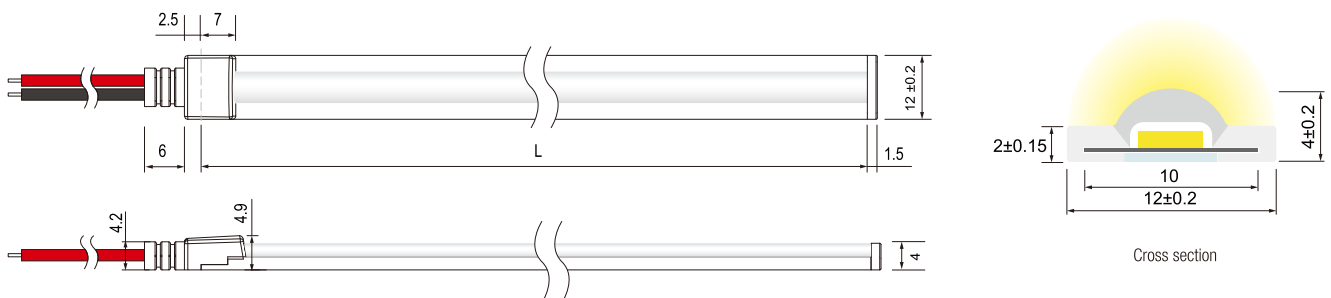

# Model : i-COB-SP12MM

## Parameter Table For 12MM

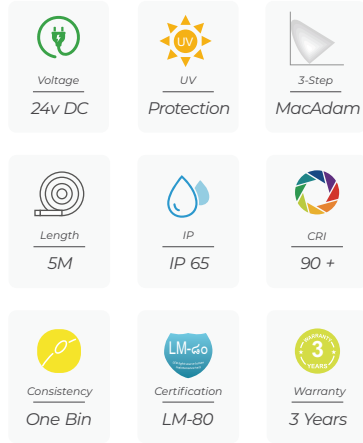

- Max. Run length refers to single side feed in serial connection.
- The given color temperature is the temperature of finished product.
- The given data are typical values due to the tolerances of the production process and the electrical components, values for light output and electrical power can vary up to 10%.

### Dual-White

CCT(K)	CRI	SDCM	Power(W)	Lumen (LM/M)	Efficiency (LM/W)	Unit Length (mm)	Max. Run Length(M)	Voltage
2700	>90	<5	5	422	84.4	83.3	5	DC24V
6500			5	434	86.8			
4000±300			10	849	84.9			
2700	>90	<5	7.5	619	82.5	83.3	5	DC24V
6500			7.5	639	85.2			
4000±300			15	1241	82.7			

### RGB

Power(W)	Color	Lumen(LM/M)	Efficiency(LM/W)	Unit Length (mm)	Max. Run Length(M)	Voltage
10	R	54	16.4	50	5	DC24V
	G	175	53.0			
	B	31	9.4			
	RGB	264	26.4			
15	R	76	15.2	50	5	DC24V
	G	233	46.6			
	B	39	7.8			
	RGB	339	22.6			

### Digital RGB

Voltage (V)	Power(W)	Color	Lumen (LM/M)	Efficiency (LM/W)	Pixel (PCS)	Signal Type	IC Model	UnitLength (mm)	Max. Run Length(M)
12	13	R	42.6	3.3	100	SPI	UCS1903	10	3
		G	141.6	10.9					
		B	33	2.5					
		RGB	208.5	16.0					



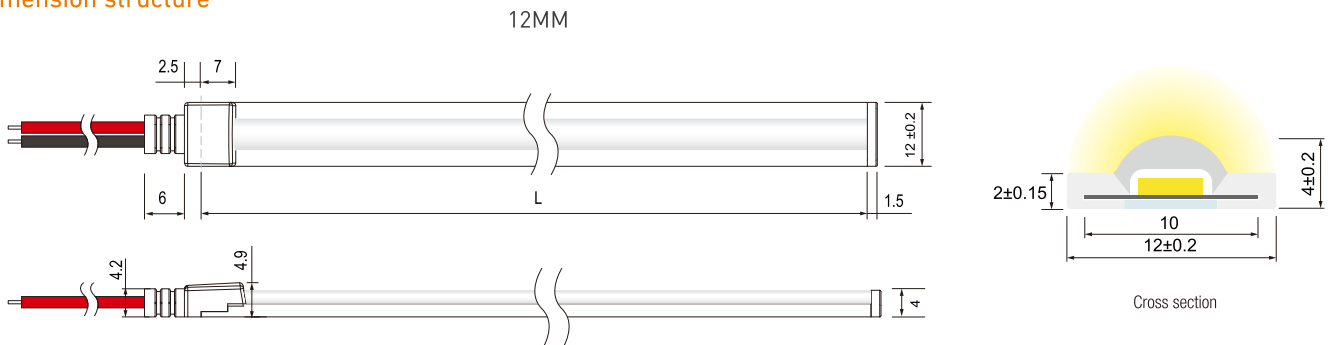

\* This maximum serial length refers to the recommended connection length of single-end power supply when the COB strip is fully loaded (RGB all on). In practical application, according to the final required effect, when the actual required power is small, the serial length can be extended as appropriate.

### Dimension structure



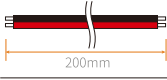
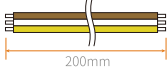

## Cable Type

Cable Type	Schematic Diagram	Specification	Core	Electrical Properties
		20AWG Red&Black 2-core Cable	● ●	Red V+, Black V-
		20AWG Brown&White&Yellow 3-core Cable	● ○ ●	Dual-White: Brown V+, White W, Yellow WW
		20AWG Brown&White&Yellow 3-core Cable	● ○ ●	Digital RGB: Brown V+, White DI, Yellow GND
PVC Cable		20AWG Black&Blue&Red&Green 4-core Cable	● ● ● ●	Black V+, Blue B, Red R, Green G
		20AWG Black&White&Blue&Green &Red 5-core Cable	● ○ ● ● ●	Black V+, White W, Blue B, GreenG, RedR
		20AWG Black&Blue&Red&Green &Yellow&White 6-core Cable	● ● ● ● ● ○	Black V+, Blue B, Red R, Green G, Yellow WW, White W

## Cutting Mark



Remark: The bottom of the led strip has transparent window, the black marker is the cutting position

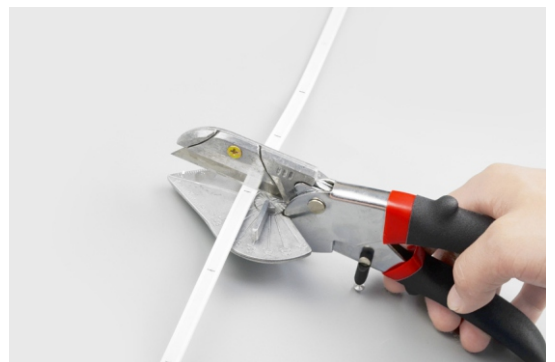

Use professional scissors to cut vertically at the cutting mark





Mounting Accessories

C8 Clip

8MM

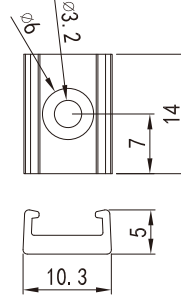

Dimension: :  
14x10.3x5

Accessories:  
PA 3X10 Self tapping screw

C10 Clip

10MM

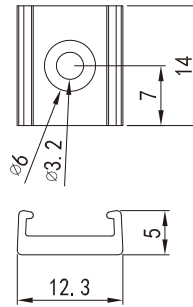
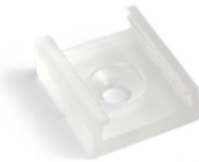

Dimension:  
14x12.3x5

Accessories:  
PA 3X10 Self tapping screw

C12 Clip

12MM

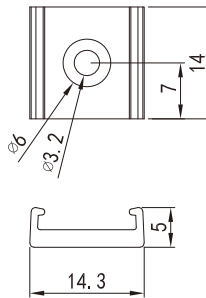

Dimension:  
14x14.3x5

Accessories:  
PA 3X10 Self tapping screw

C14 Clip

14MM

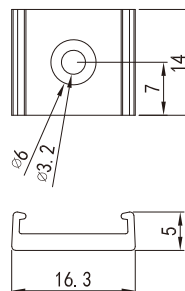

Dimension:  
14x16.3x5

Accessories:  
PA 3X10 Self tapping screw



Single Color Connection Diagram

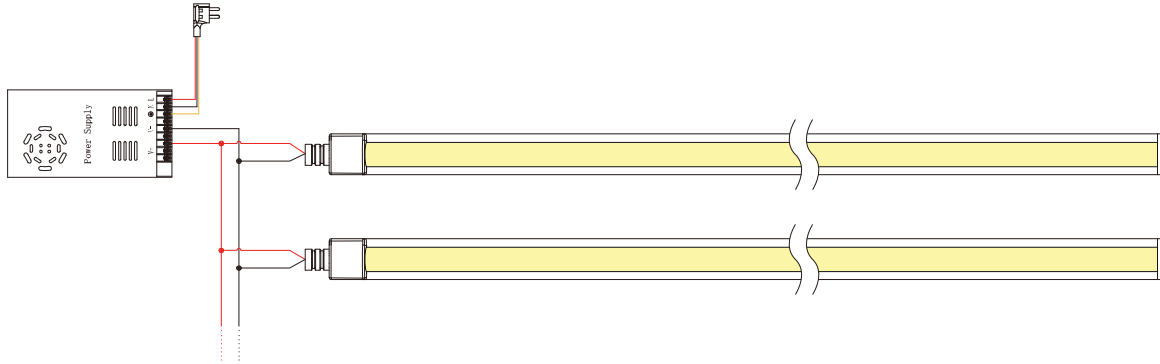

Tunable white Connection Diagram

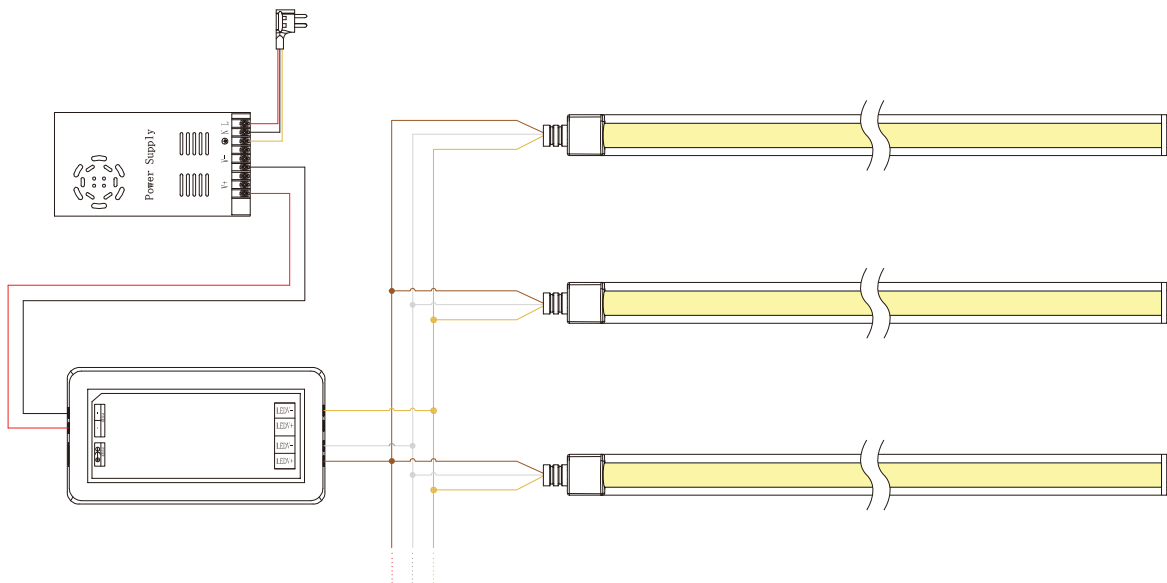



RGB Connection Diagram

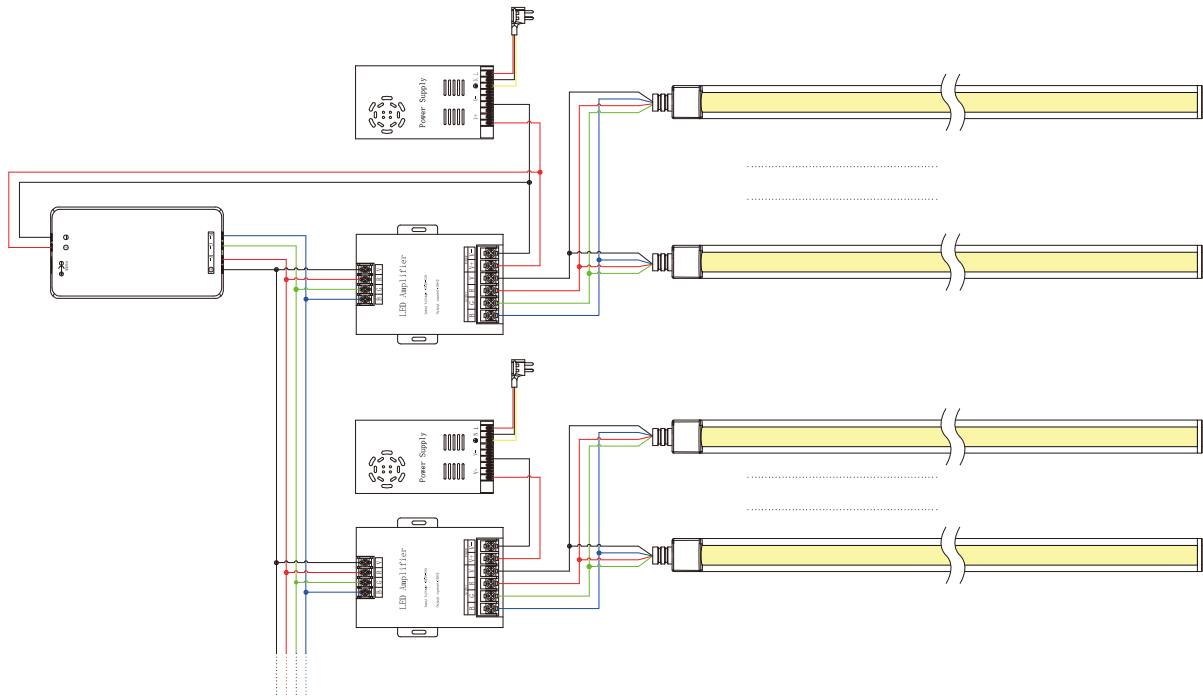

RGBW Connection Diagram

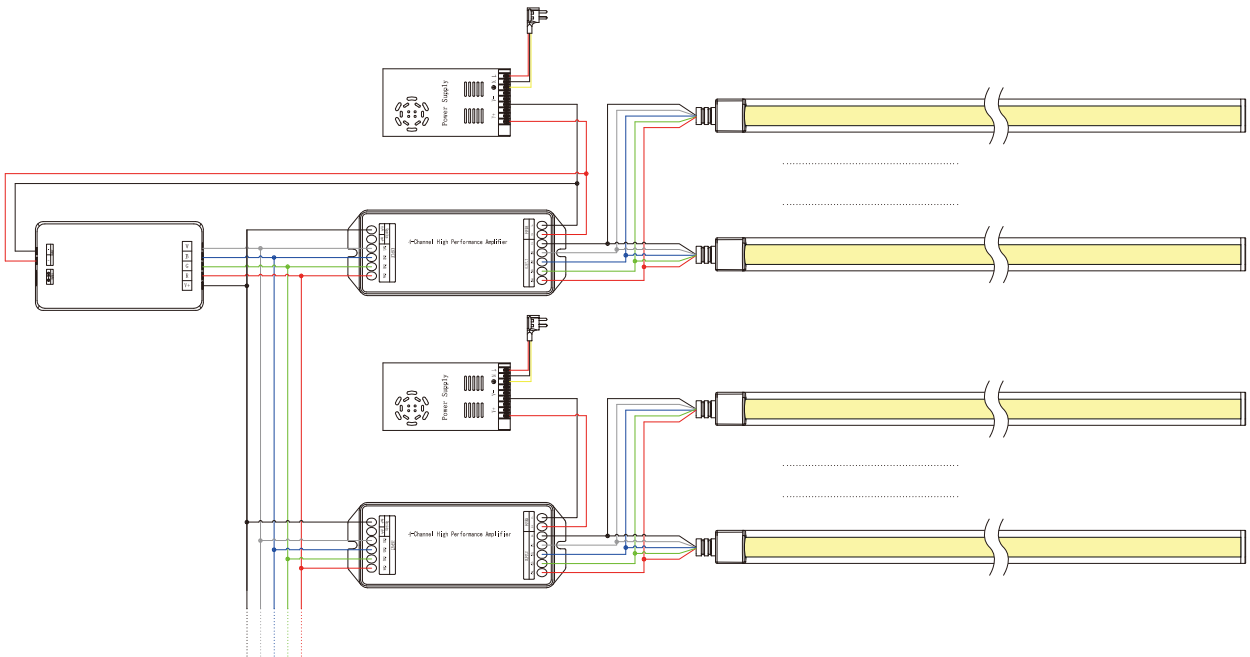



RGBWW Connection Diagram

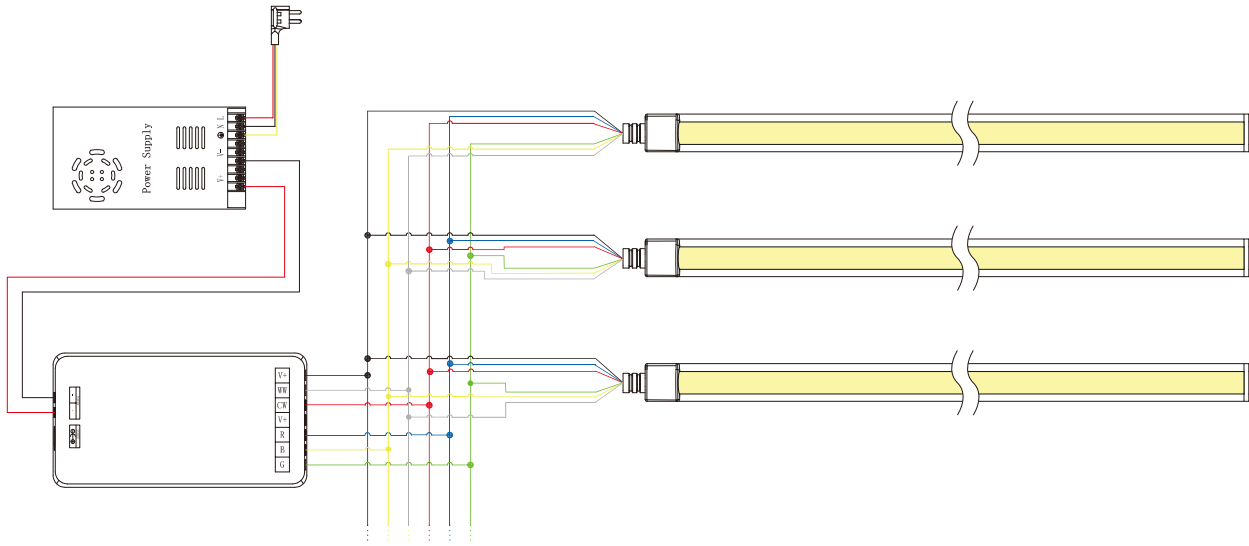

Digital RGB Connection Diagram

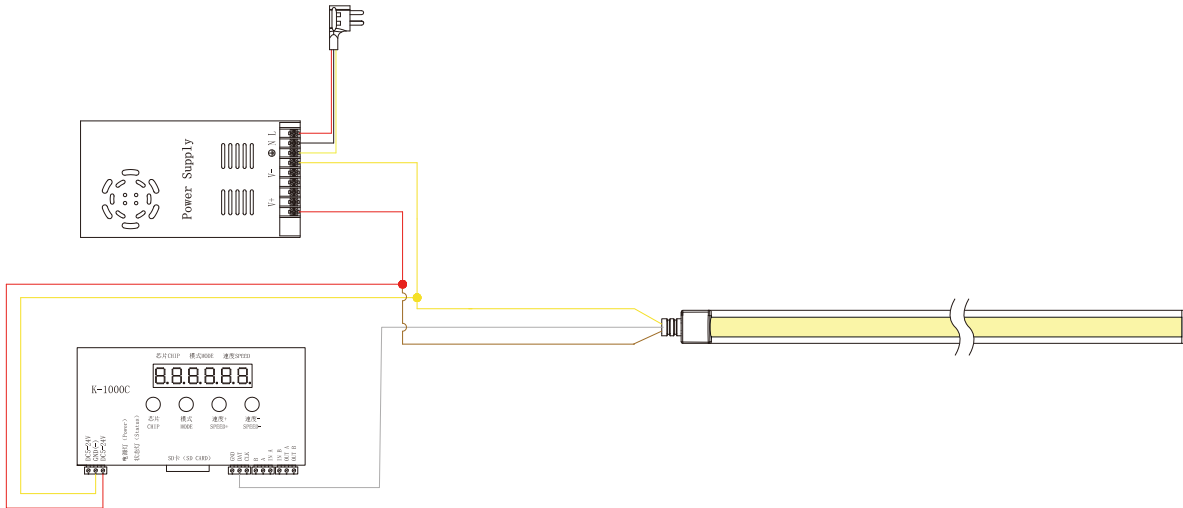



Installation Diagram

Installation with 3M tape

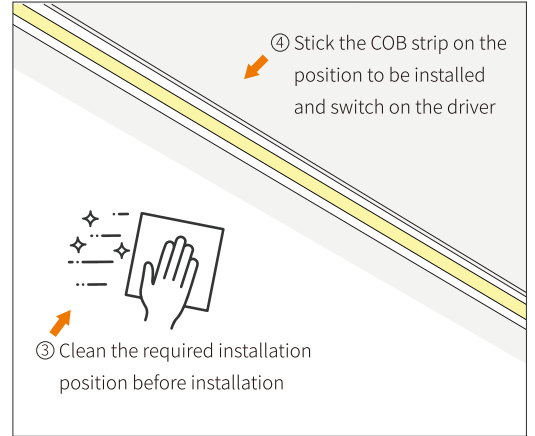
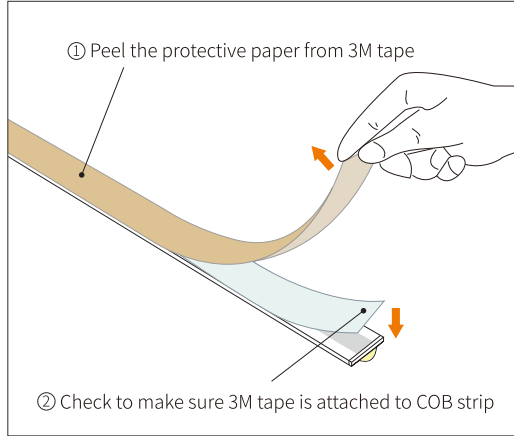

Installation with aluminum clips

